

Loud Speaker

SN6083S001



DIMENSIONS

UNIT:mm

Tolerance:± 0.2mm

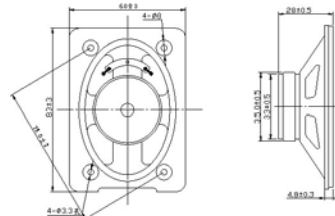

SPECIFICATIONS

FREQUENCY RESPONSE

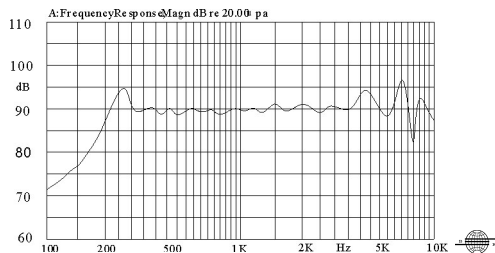

Rated Impedance	Ω	50 ± 15%
Rated Input Power	W	0.5
Maximum Input Power	W	1.0
Resonant Frequency	Hz	280 ± 20%
Sound Pressure Level 1W/0.5m(AVG0.8,1.0,1.2,1.5)KHz	dB	88 ± 3
Weight	g	79
Operating Temperature Range	°C	-10~+40
Storage Temperature Range	°C	-20~+80