

Loud Speaker

SN50S006



DIMENSIONS

UNIT:mm

Tolerance:± 0.5mm

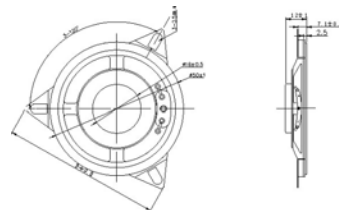

SPECIFICATIONS

FREQUENCY RESPONSE

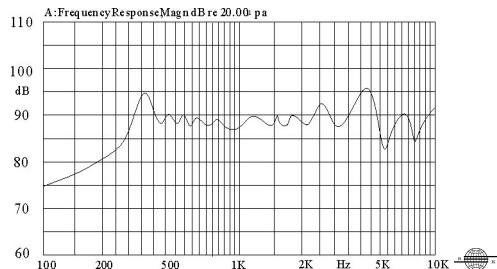

Rated Impedance	Ω	16 ± 15%
Rated Input Power	W	0.2
Maximum Input Power	W	0.5
Resonant Frequency	Hz	380 ± 20%
Sound Pressure Level 1W/0.5m(AVG0.8,1.0,1.2,1.5)KHz	dB	88 ± 3
Weight	g	19.8
Operating Temperature Range	°C	-10~+40
Storage Temperature Range	°C	-20~+80