

Loud Speaker

SN100S001



DIMENSIONS

UNIT:mm

Tolerance:± 0.2mm

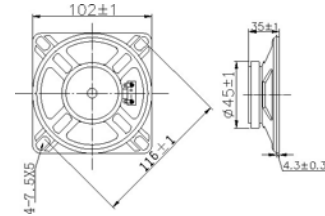

SPECIFICATIONS

Rated Impedance	Ω	8 ± 15%
Rated Input Power	W	2
Maximum Input Power	W	5
Resonant Frequency	Hz	260 ± 20%
Sound Pressure Level 1W/0.5m(AVG0.8,1.0,1.2,1.5)KHz	dB	92 ± 3
Weight	g	130
Operating Temperature Range	°C	-10~+40
Storage Temperature Range	°C	-20~+80

FREQUENCY RESPONSE

