

# Receiver

## SM31R001



### DIMENSIONS

UNIT:mm

Tolerance:± 0.5mm

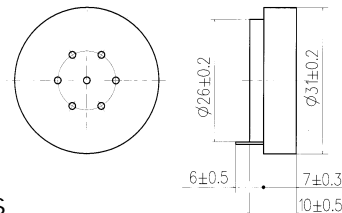

### SPECIFICATIONS

DC Resistance	$\Omega$	$135 \pm 10\%$
AC Impedance	$\Omega$	$150 \pm 20\%$
Sensitivity	dB	$108 \pm 3$ at 1mW
Frequency Range	Hz	300~4000
THD		$\leq 2\%$
Operating Temperature	$^{\circ}\text{C}$	-10~+40
Weight	g	15

### FREQUENCY RESPONSE

