

Speaker

SM27S002



DIMENSIONS

UNIT:mm

Tolerance:± 0.5mm

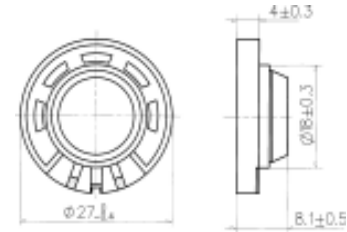

SPECIFICATIONS

FREQUENCY RESPONSE

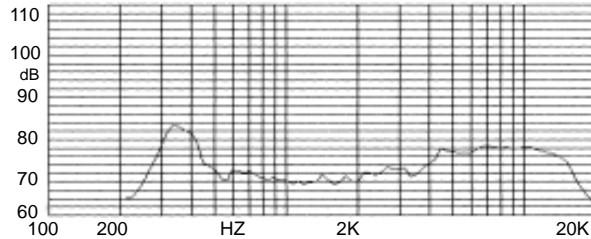

Rated Impedance	Ω	8 ± 15%
Rated Input Power	W	0.1
Maximum Input Power	W	0.15
Resonant Frequency	Hz	300 ± 20%
S.P.L@0.1w/0.1m@1kHz	dB	68 ± 3
Weight	g	2
Operating Temperature Range	℃	-10~+40
Storage Temperature Range	℃	-30~+70