

Speaker

SM23S003



DIMENSIONS

UNIT:mm

Tolerance: $\pm 0.2\text{mm}$

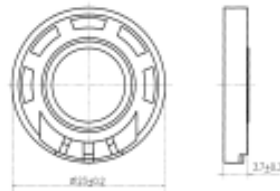

SPECIFICATIONS

Rated Impedance	Ω	$8 \pm 20\%$
Rated Input Power	W	0.1
Maximum Input Power	W	0.2
Resonant Frequency	Hz	$1000 \pm 20\%$
S.P.L@0.1w/0.1m@1kHz	dB	75 ± 3
Weight	g	1
Operating Temperature Range	$^{\circ}\text{C}$	-10~+40
Storage Temperature Range	$^{\circ}\text{C}$	-40~+80

FREQUENCY RESPONSE

