

# Speaker

## SM23S002



### DIMENSIONS

UNIT:mm

Tolerance:± 0.2mm

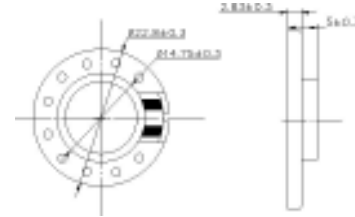

### SPECIFICATIONS

Rated Impedance	Ω	8 ± 15%
Rated Input Power	W	0.2
Maximum Input Power	W	0.5
Resonant Frequency	Hz	600 ± 20%
S.P.L@0.1w/0.1m@1kHz	dB	85 ± 3
Weight	g	3.4
Operating Temperature Range	°C	-20~+40
Storage Temperature Range	°C	-30~+80

### FREQUENCY RESPONSE

